

- = Oak post memorial locations
- = Footpaths
- = Hedges or fences

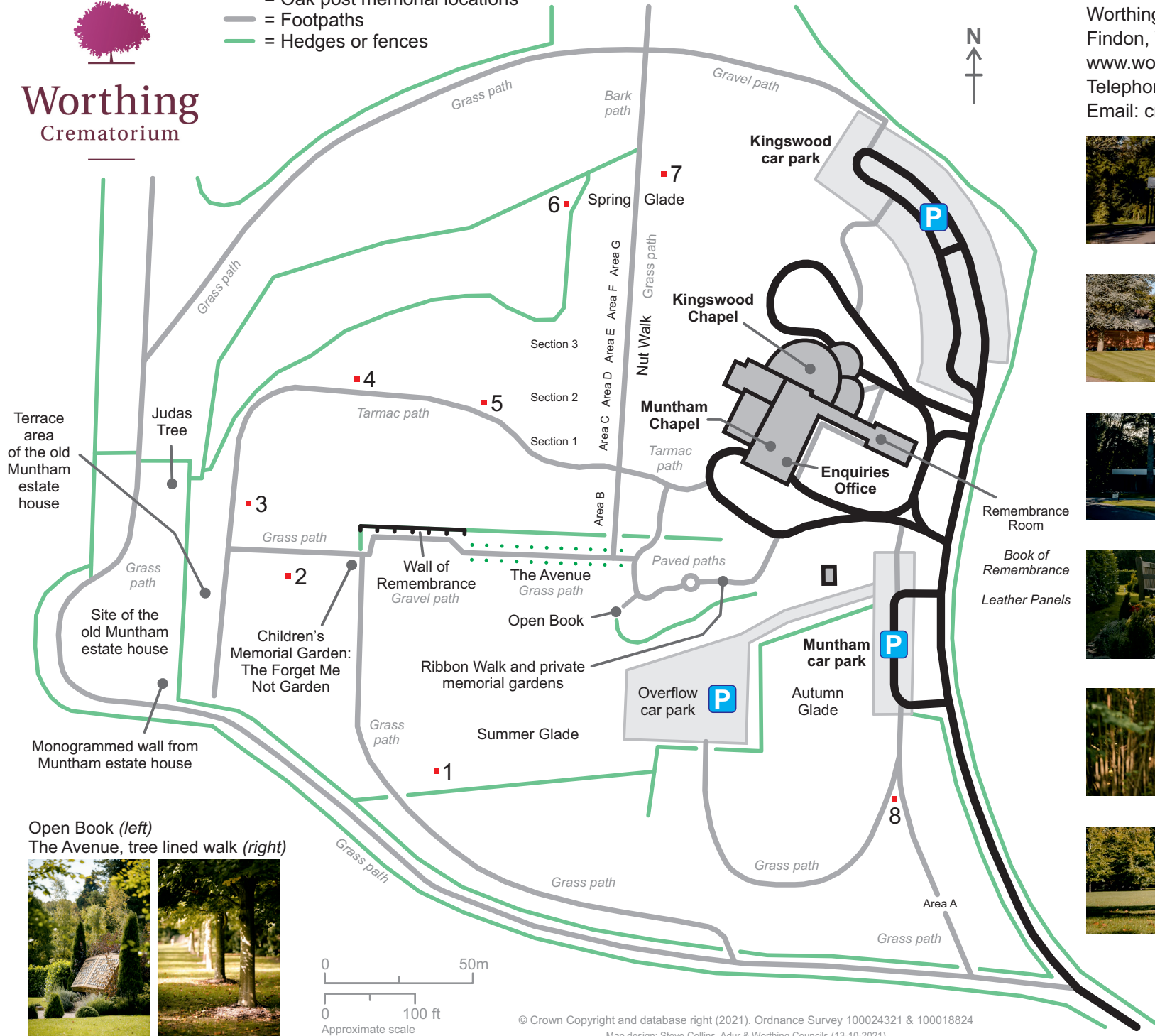

Worthing Crematorium, Horsham Road,
Findon, West Sussex, BN14 0RG
www.worthingcrem.co.uk
Telephone: 01903 872678
Email: crematorium@worthing.gov.uk



Muntham Chapel



Remembrance Room

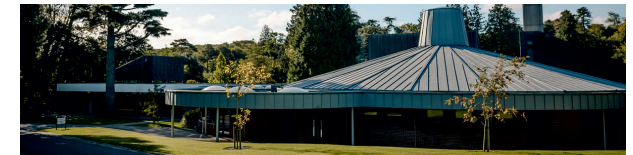

Kingswood Chapel

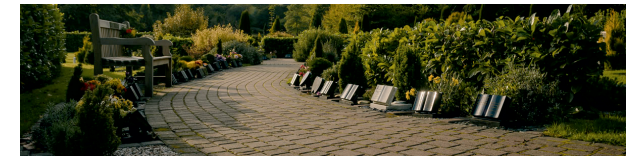

Ribbon Walk, private memorial garden

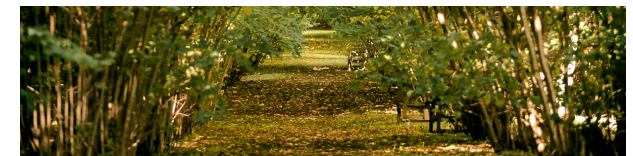

Nut Walk - wooded walk



View across the lawns towards the private gardens and buildings

Terrace area of the old Muntham estate house

Judas Tree

Site of the old Muntham estate house

Monogrammed wall from Muntham estate house

Children's Memorial Garden:
The Forget Me Not Garden

Ribbon Walk and private memorial gardens

Summer Glade

Open Book

The Avenue
Grass path

Wall of Remembrance
Gravel path

Grass path

3

Section 3

Section 2

Section 1

6

Spring

Glade

Kingswood car park

Kingswood Chapel

Muntham Chapel

Enquiries Office

Remembrance Room

Book of Remembrance

Leather Panels

Muntham car park

Autumn Glade

Overflow car park

8

Area A

Grass path

Grass path

Grass path

Grass path

Open Book (left)

The Avenue, tree lined walk (right)

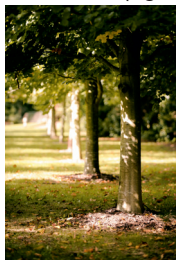
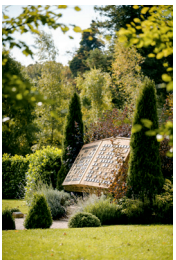

0 50m
0 100 ft
Approximate scale

Main access road to/from the A24
(approximately 3/4 mile)